

mod. **EURFLOW**
single jet - super dry



Mod. EURFLOW

Getto unico, quadrante asciutto, lettura diretta su 8 rulli numeratori. Realizzato nelle versioni per acqua fredda (30° C) e calda (90° C) nei calibri \varnothing 15 e 20 mm (1/2" e 3/4"). Quadrante orientabile su 360°. Dotato di calotta antifrode. Esclusi rischi di corrosione e sedimentazione. Garanzia di lunga durata ed elevata precisione.

Mod. EURFLOW

Single jet, dry dial, direct reading on 8 numerical rolls. Produced in the versions cold water (30° C) and hot water (90° C) in the diameters 15 and 20 mm (1/2"- 3/4"). Dial can rotate 360°. Mounted with anti-fraud cap. Risks of corrosion and sedimentation are excluded. Guaranteed long durability and elevated precision.

Mod. EURFLOW

Chorro único, cuadro seco, lectura directa sobre 8 rodillos numerados. Realizado en las versiones para agua fría (30° C) y agua caliente (90° C) en los calibres de \varnothing 15 y 20 mm (1/2" y 3/4"). Cuadro orientable a 360°. Dotado de antifraude. Libre de riesgos de corrosión y sedimentación. Garantía de larga duración y elevada precisión.

Mod. EURFLOW

Jet unique, cadran sec à lecture directe sur 8 rouleaux numériques, disponible en version eau froide (30° C) ou eau chaude (90° C) eten 2 calibres 15 ou 20 mm (1/2" ou 3/4"), cadran orientable à 360°, équipé d' une bague d' inviolabilité exclus tous problèmes de risques de corrosion et d' incrustation, fiabilité dans le temps et précision élevée.

Mod. EURFLOW

Einzelwasserstrahl, trockenes Ziffernblatt, Direktablesung auf 8 Zahlrollen. Produziert in den Versionen Kaltwasser (30 Grad) und Warmwasser (90 Grad) in den Durchmesser 15 und 20 mm (1/2 Zoll-3/4 Zoll). Um 360 Grad schwenkbares Ziffernblatt. Ausgestattet mit anti-Betrug Aufsatz. Die Risiken von Rost und Ablagerungen sind ausgeschlossen. Garantiert lange Haltbarkeit und erhöhte Genauigkeit.

Мод. EURFLOW

Одноструйный, сухоходный, крыльчатый счётчик холодной (30°С) и горячей (90°С) воды, прямой считывание на 8 роликов. С диаметром условного прохода 15 или 20мм (1/2"– 3/4"). Вращаемый на 360°циферблат. С механизмом анти-фальсификации, с антимагнитной защитой. Исключены риски коррозии и осаджения. Гарантия долговечности и высокой точности.

Caratteristiche tecniche - Technical features

Calibro Size	DN	mm in	15 (1/2")	20 (3/4")
Portata massima Max flow rate	Qmax	m ³ /h	3	5
Portata nominale Nominal flow rate	Qn	m ³ /h	1,5	2,5
Portata di transizione Transitional flow rate	Qt ±2%	l/h	120	200
Portata minima Min flow rate	Qmin ±5%	l/h	30	50
Lettura minima Min reading		l	0,05	0,05
Lettura massima Max reading		m ³	100.000	100.000
Pressione max di esercizio Max working pressure		bar	16	16

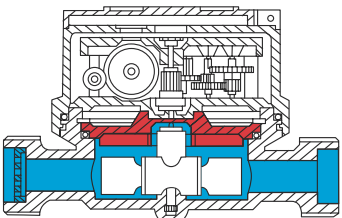
Classe B-H/A-V Class B-H/A-V	
Acqua fredda 0°- 30°C Cold water 0°- 30°C	
Acqua calda 30°- 90°C Hot water 30°- 90°C	
Trascinamento magnetico Magnetic transmission	
Quadrante orientabile su 360° 360° revolving dial	
Piastra di tenuta antigelo su richiesta Antifrost sealing plate on request	
Orologeria superiore a tenuta Water proof mechanism	
Calotta anti frode - Corpo nichelato Anti-fraud cap - Chromed case	
Dispositivo antimagnetico su richiesta Anti magnetic protection device on request	
Codice a barre personalizzabile su richiesta Bar code customizable on request	

Dimensioni e pesi - Dimensions and weights

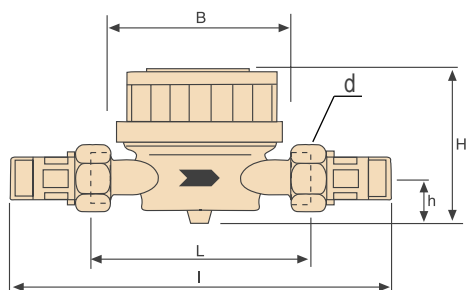

Calibro Size	mm in	15 1/2"	20 3/4"	
L	mm	110	130	
I	mm	190	228	
H	mm	66	71	
h	mm	13	18	
B	mm	73	73	
d	in	3/4"	1"	
Pesi Weights	con raccordi with unions	Kg	0,65	0,80
	senza raccordi without unions	Kg	0,50	0,55

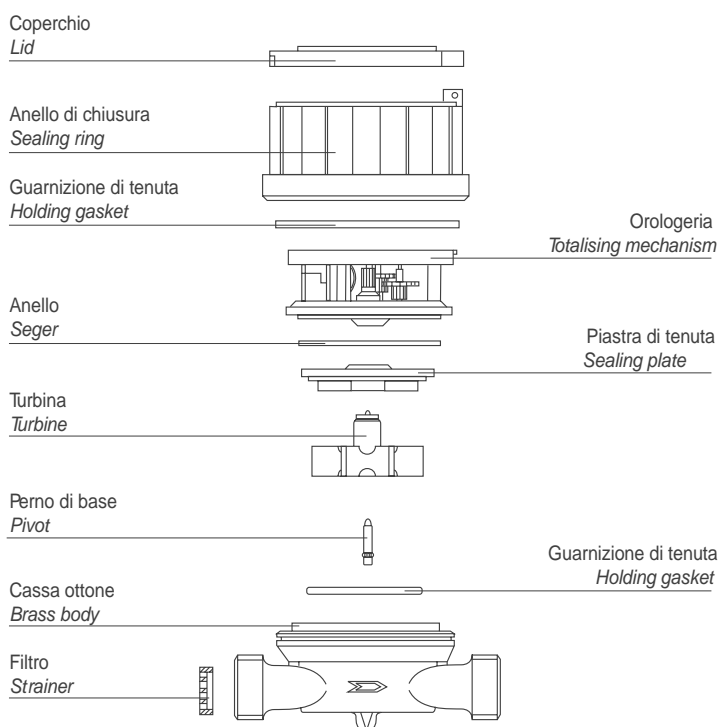

Curva tipica degli errori dei contatori a turbina Typical error curve of turbine meters

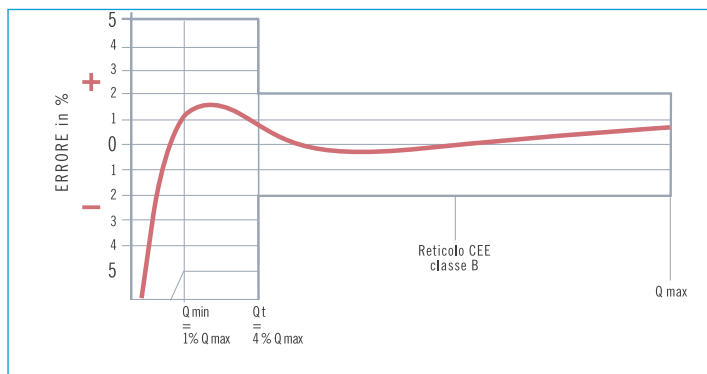

Curva delle perdite di carico dei contatori ø 15 e 20 mm Loss of head curve of ø 15 and 20 mm water meters

